

Steps in using bubble diagrams

1. List functions to be performed (ex: museum)

storage, operations, administration, educational, gift shop, exhibits, prep areas, café, staff area, children's area, public restrooms

2. Rank functions according to size allocation (approximate square footage)

exhibits

storage

operations, administration

educational

children's areas

public restrooms, prep area, staff area

café, gift shop

3. Taking circulation between spaces into consideration, draw bubbles (drawn to proportional relationship)



4. Evaluate placement of bubbles using design parameters

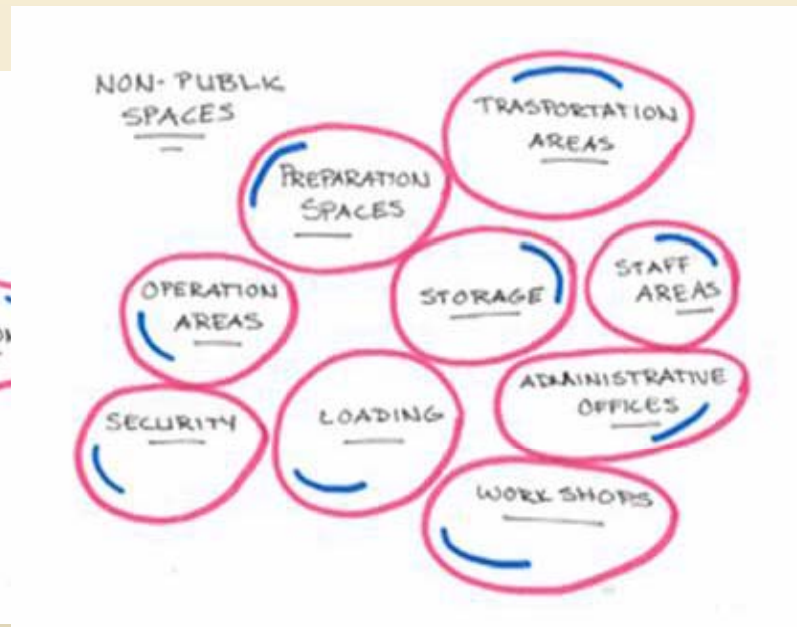

5. Using overlays, rearrange bubbles until best layout is achieved that satisfies design parameters



6. From final bubble diagram create a preliminary design

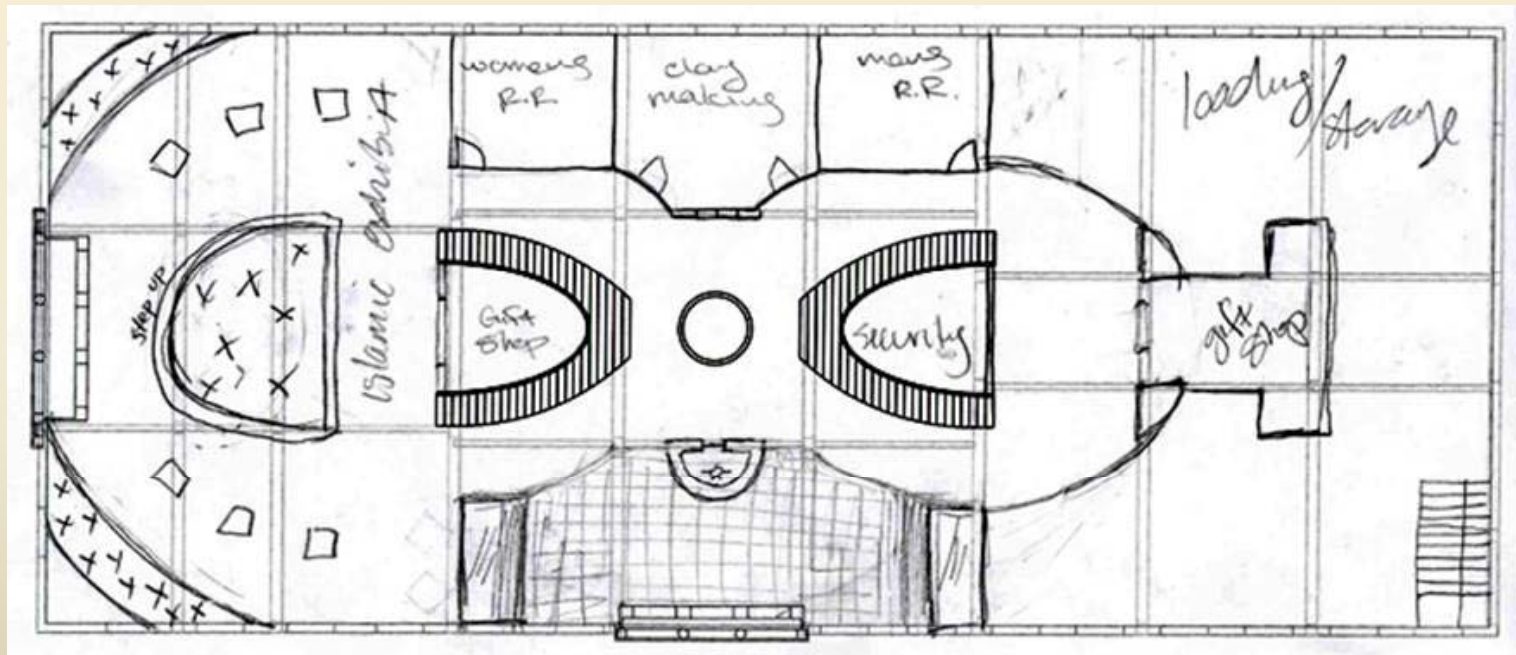

Further develop preliminary floor plan

